



CITY of NOVI CITY COUNCIL

Agenda Item B
May 19, 2014

SUBJECT: Approval to purchase replacement office furniture for the customer service area at the Department of Public Services from ISCG Inc., in the amount of \$18,158, based on the State of Michigan's MiDeal cooperative purchasing program.

SUBMITTING DEPARTMENT: Department of Public Services, Administration Division *BM*
Facility Operations *BM*

CITY MANAGER APPROVAL: *[Signature]*

EXPENDITURE REQUIRED	\$18,158
AMOUNT BUDGETED	\$50,000
APPROPRIATION REQUIRED	\$0
LINE ITEM NUMBER	101-442.00-976.000

BACKGROUND INFORMATION:

The Department of Public Services facility dates back to 1985 and so does most of the office furniture (see attached photographs of existing furniture). Many of the workstations in the customer service bullpen area are past the point of repair and are in need of replacement, not only due to increased safety concerns but also because of diminished aesthetics. The proposed furniture and layout will allow the best use of the space to provide a better image to the public and a better work environment for improved staff productivity.

The project includes removal of existing cubicle furniture, and demolition of wall cabinets and counter tops. Once the front office area is prepped, new cubicles, desks, chairs and filing cabinets will be installed.

The furniture proposed is manufactured by Haworth from their Unigroup Too line and installation will be scheduled in one phase to allow the least impact on normal business operations while providing optimal contractor scheduling. The pricing is based on the State of Michigan (MiDeal) cooperative purchasing contract. Plans and photographs of the furniture are attached.

This project aligns with City Councils goal to fund capital improvements to Public Services' facilities.

RECOMMENDED ACTION: Approval to purchase replacement office furniture for the customer service area at the Department of Public Services from ISCG Inc., in the amount of \$18,158, based on the State of Michigan's MiDeal cooperative purchasing program.

	1	2	Y	N
Mayor Gatt				
Mayor Pro Tem Staudt				
Council Member Casey				
Council Member Fischer				

	1	2	Y	N
Council Member Markham				
Council Member Mutch				
Council Member Wrobel				



Representative picture of existing cubicle materials_1



Representative picture of existing cubicle materials_2

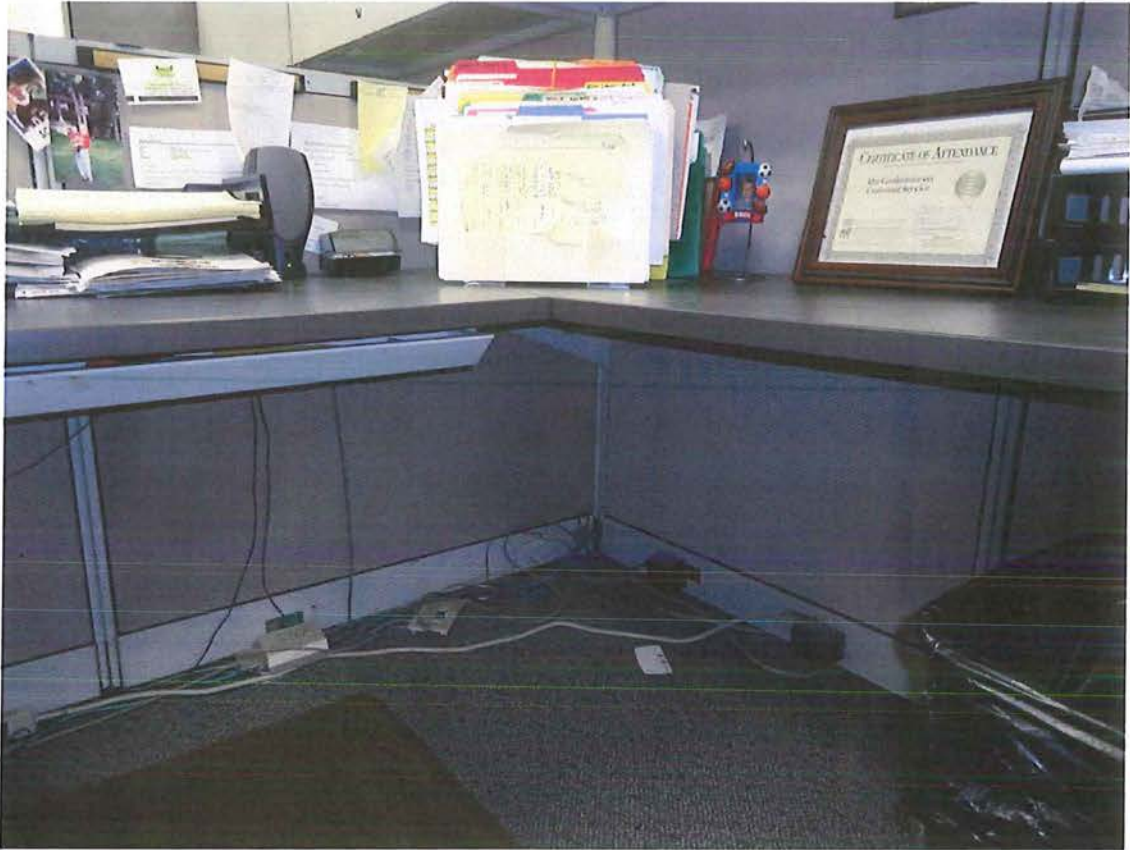

Representative picture of existing cubicle materials_3



Representative picture of existing cubicle materials_4



Representative picture of existing cubicle materials_5



Representative picture of existing cubicle materials_6

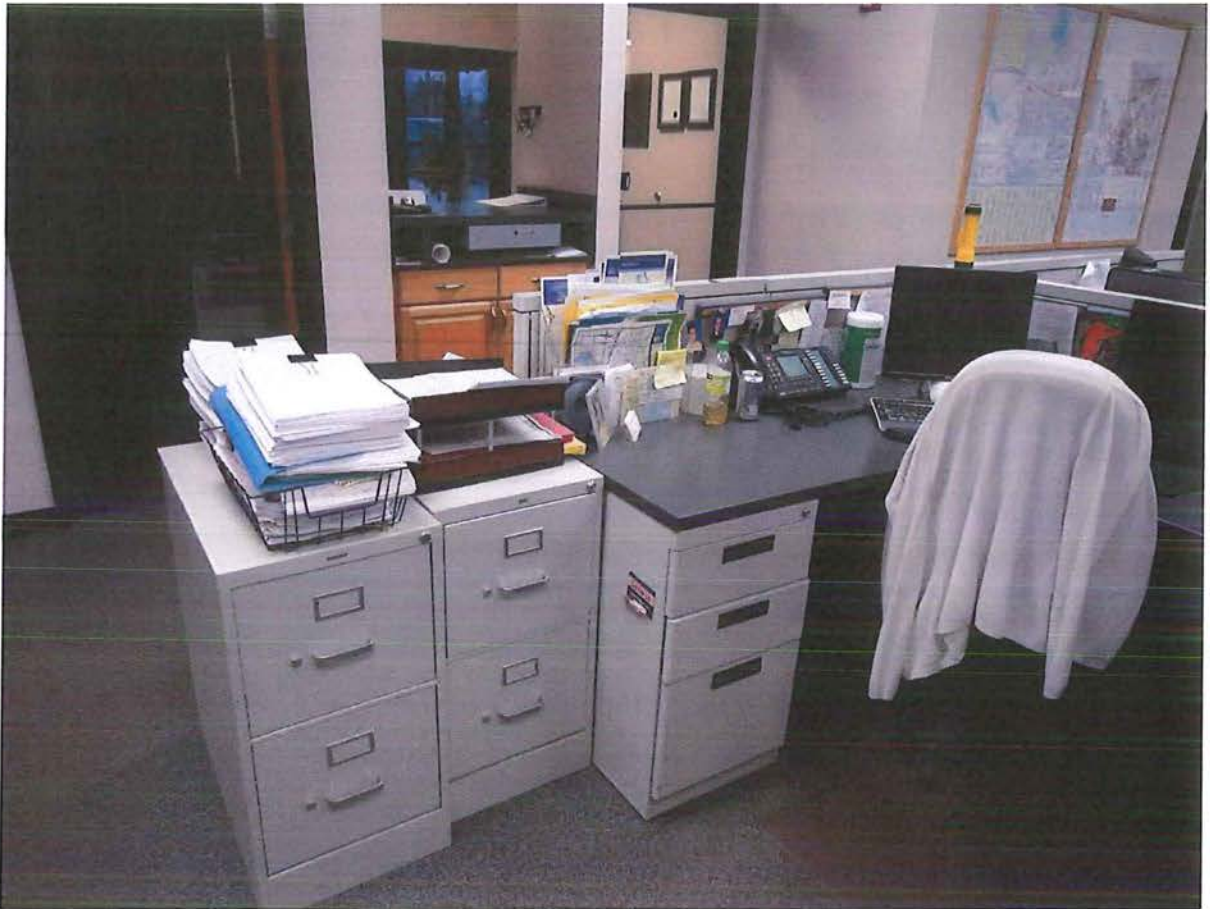

Representative picture of existing cubicle materials_7



PROPOSAL
PROPOSAL: 93938

DATE: 04/14/14
PROJECT #: 20-395

PROPOSAL FOR: CITY OF NOVI 45175 W. 10 MILE RD. NOVI, MI 48375	INSTALL AT: CITY OF NOVI 45175 W. 10 MILE RD. NOVI, MI 48375
---	---

COST CENTER:

SALESPERSON: JOEL MILLER	CLIENT: 010030	YOUR P/O:	QUOTE VALID
-----------------------------	-------------------	-----------	-------------

#	QTY	PRODUCT	DESCRIPTION	SELL	EXTENDED
1	7	Z831-1442 () ,1N- 008 ,TR- 00F	LOOK,MID-BACK, SYNCHRO, FIXED ARM,HARD CASTER,NO LOCK STANDARD VERSION CHR FAB - HORIZON GRADE A SKYLINE SURFACE 2 BLACK Tag(s): 1ST FL	189.08	1,323.56
2	4	JPTH-24-SJ (SJ) ,TR- 00E ,LR- 0BP	X SERIES, PEDESTAL, TUG, BOX/BOX/FI LE 24"D PTD FRT,J STL PULL SURFACE 1 SMOKE LOCK PLUG/RING/GROMMET COLORS CHROME (BRIGHT NICKEL PLATE)	234.30	937.20
3	4	E2BN-338-B (B) ,TR- 00E ,TR-	MONO PANEL CORE-NO SURF OPTION,SQ TOP CAP,NO-PWR,36"W X 40"H POWER BASE SURFACE 1 SMOKE SURFACE 2 CONTINUED...	76.83	307.32



PROPOSAL

PROPOSAL: 93938

DATE: 04/14/14
PROJECT #: 20-395

PROPOSAL FOR:
CITY OF NOVI
45175 W. 10 MILE RD.
NOVI, MI 48375

INSTALL AT:
CITY OF NOVI
45175 W. 10 MILE RD.
NOVI, MI 48375

COST CENTER:

SALESPERSON: JOEL MILLER CLIENT: 010030 YOUR P/O: QUOTE VALID

#	QTY	PRODUCT	DESCRIPTION	SELL	EXTENDED
		00E	SMOKE		
4	1	E2CC-90-4	90DEG TOP CAP, FOR 2-, 3-, OR 4-WAY	7.80	7.80
		(4) ,TR- 00E	FOUR-WAY SURFACE 1 SMOKE		
5	2	E2FM-6400-3	TOP FEED MODULE, PANEL HEIGHT 64"-80"	194.42	388.84
		(3) ,TR- 00E ,TR- 00E	3-CIRCUIT SURFACE 1 SMOKE SURFACE 2 SMOKE		
6	1	E2FS-24-N	180DEG FINISH POST, VERTICAL COVER ONLY, FABRIC, 24"H	6.24	6.24
		(N) ,C1- OAM	VERTICAL COVER ONLY SYS/WALL - STRIAE, GRADE A BAND Tag(s): 1ST FL		



PROPOSAL
PROPOSAL: 93938

DATE: 04/14/14
PROJECT #: 20-395

PROPOSAL FOR: CITY OF NOVI 45175 W. 10 MILE RD. NOVI, MI 48375	INSTALL AT: CITY OF NOVI 45175 W. 10 MILE RD. NOVI, MI 48375
---	---

COST CENTER:

SALESPERSON: JOEL MILLER	CLIENT: 010030	YOUR P/O:	QUOTE VALID
-----------------------------	-------------------	-----------	-------------

#	QTY	PRODUCT	DESCRIPTION	SELL	EXTENDED
7	5	E2FS-62 () ,C1- 0AM ,TR- 00E ,TR- 00E	180DEG FINISH POST, FABRIC, 64"H FULL-HEIGHT SYS/WALL - STRIAE, GRADE A BAND SURFACE 2 SMOKE SURFACE 3 SMOKE	14.43	72.15
8	1	E2FS-62-V2I (V2I) ,C1- 0AM ,TR- 00E ,TR- 00E	180DEG FINISH POST, FABRIC, 64"H VARIABLE HT (2-WAY STRGHT CAP) SYS/WALL - STRIAE, GRADE A BAND SURFACE 2 SMOKE SURFACE 3 SMOKE Tag(s): 1ST FL	16.77	16.77
9	4	SPLE-9895 ,OH- 0AE	SINGLE BASE INSERT-FOR MONO PANEL CORE, LAMINATE, 36"W X 32"H LAMINATE MAPLE	97.50	390.00



PROPOSAL

PROPOSAL: 93938

DATE: 04/14/14
PROJECT #: 20-395

PROPOSAL FOR:
CITY OF NOVI
45175 W. 10 MILE RD.
NOVI, MI 48375

INSTALL AT:
CITY OF NOVI
45175 W. 10 MILE RD.
NOVI, MI 48375

COST CENTER:

SALESPERSON: JOEL MILLER CLIENT: 010030 YOUR P/O: QUOTE VALID

#	QTY	PRODUCT	DESCRIPTION	SELL	EXTENDED
10	4	E2JF-338 ,C1- OAM	SINGLE BASE INSERT-FOR MONO PANEL CORE,FABRIC,36"W X 40"H SYS/WALL - STRIAE,GRADE A BAND	21.65	86.60
11	4	E2MN-262-B (B) ,C1- OAM ,C1- OAM ,TR- 00E ,TR- 00E	MONO PANEL,SQ TOP CAP,NO-POWER,24"W X 64"H POWER BASE SYS/WALL - STRIAE,GRADE A BAND SYS/WALL - STRIAE,GRADE A BAND SURFACE 3 SMOKE SURFACE 4 SMOKE	97.89	391.56
12	2	E2MN-3046-B (B) ,C1- OAM ,C1- OAM ,TR-	MONO PANEL,SQ TOP CAP,NO-POWER,30"W X 48"H POWER BASE SYS/WALL - STRIAE,GRADE A BAND SYS/WALL - STRIAE,GRADE A BAND SURFACE 3 CONTINUED...	105.11	210.22



PROPOSAL
PROPOSAL: 93938

DATE: 04/14/14
PROJECT #: 20-395

PROPOSAL FOR: CITY OF NOVI
45175 W. 10 MILE RD.
NOVI, MI 48375

INSTALL AT: CITY OF NOVI
45175 W. 10 MILE RD.
NOVI, MI 48375

COST CENTER:

SALESPERSON: JOEL MILLER CLIENT: 010030 YOUR P/O: QUOTE VALID

#	QTY	PRODUCT	DESCRIPTION	SELL	EXTENDED
		00E ,TR- 00E	SMOKE SURFACE 4 SMOKE		
13	8	E2MN-362-B	MONO PANEL,SQ TOP CAP,NO-POWER,36"W X 64"H	121.29	970.32
		(B) ,C1- 0AM ,C1- 0AM ,TR- 00E ,TR- 00E	POWER BASE SYS/WALL - STRIAE,GRADE A BAND SYS/WALL - STRIAE,GRADE A BAND SURFACE 3 SMOKE SURFACE 4 SMOKE		
14	1	E2MN-4262-B	MONO PANEL,SQ TOP CAP,NO-POWER,42"W X 64"H	130.65	130.65
		(B) ,C1- 0AM ,C1- 0AM ,TR-	POWER BASE SYS/WALL - STRIAE,GRADE A BAND SYS/WALL - STRIAE,GRADE A BAND SURFACE 3 CONTINUED...		



PROPOSAL

PROPOSAL: 93938

DATE: 04/14/14
PROJECT #: 20-395

PROPOSAL FOR:
CITY OF NOVI
45175 W. 10 MILE RD.
NOVI, MI 48375

INSTALL AT:
CITY OF NOVI
45175 W. 10 MILE RD.
NOVI, MI 48375

COST CENTER:

SALESPERSON: JOEL MILLER CLIENT: 010030 YOUR P/O: QUOTE VALID

#	QTY	PRODUCT	DESCRIPTION	SELL	EXTENDED
		00E ,TR- 00E	SMOKE SURFACE 4 SMOKE		
15	1	E2MP-262-B	MONO PANEL,SQ TOP CAP,W/POWER,24"W X 64"H	128.12	128.12
		(B) ,C1- 0AM ,C1- 0AM ,TR- 00E ,TR- 00E	POWER BASE SYS/WALL - STRIAE,GRADE A BAND SYS/WALL - STRIAE,GRADE A BAND SURFACE 3 SMOKE SURFACE 4 SMOKE		
16	1	E2MP-3062-B	MONO PANEL,SQ TOP CAP,W/POWER,30"W X 64"H	141.38	141.38
		(B) ,C1- 0AM ,C1- 0AM ,TR-	POWER BASE SYS/WALL - STRIAE,GRADE A BAND SYS/WALL - STRIAE,GRADE A BAND SURFACE 3 CONTINUED...		



PROPOSAL
PROPOSAL: 93938

DATE: 04/14/14
PROJECT #: 20-395

PROPOSAL FOR: CITY OF NOVI
45175 W. 10 MILE RD.
NOVI, MI 48375

INSTALL AT: CITY OF NOVI
45175 W. 10 MILE RD.
NOVI, MI 48375

COST CENTER:

SALESPERSON: JOEL MILLER CLIENT: 010030 YOUR P/O: QUOTE VALID

#	QTY	PRODUCT	DESCRIPTION	SELL	EXTENDED
		00E ,TR- 00E	SMOKE SURFACE 4 SMOKE		
17	9	E2MP-362-B	MONO PANEL,SQ TOP CAP,W/POWER,36"W X 64"H (B) POWER BASE ,C1- SYS/WALL - STRIAE,GRADE A 0AM BAND ,C1- SYS/WALL - STRIAE,GRADE A 0AM BAND ,TR- SURFACE 3 00E SMOKE ,TR- SURFACE 4 00E SMOKE Tag(s): 1ST FL	151.52	1,363.68
18	1	E2MP-4238-B	MONO PANEL,SQ TOP CAP,W/POWER,42"W X 40"H (B) POWER BASE ,C1- SYS/WALL - STRIAE,GRADE A 0AM BAND ,C1- SYS/WALL - STRIAE,GRADE A 0AM BAND CONTINUED...	146.25	146.25



PROPOSAL
 PROPOSAL: 93938

DATE: 04/14/14
 PROJECT #: 20-395

PROPOSAL FOR: CITY OF NOVI
 45175 W. 10 MILE RD.
 NOVI, MI 48375

INSTALL AT: CITY OF NOVI
 45175 W. 10 MILE RD.
 NOVI, MI 48375

COST CENTER:

SALESPERSON: JOEL MILLER CLIENT: 010030 YOUR P/O: QUOTE VALID

#	QTY	PRODUCT	DESCRIPTION	SELL	EXTENDED
		,TR-00E	SURFACE 3 SMOKE		
		,TR-00E	SURFACE 4 SMOKE		
19	1	E2MP-4262-B	MONO PANEL,SQ TOP CAP,W/POWER,42"W X 64"H	160.88	160.88
		(B)	POWER BASE		
		,C1-0AM	SYS/WALL - STRIAE, GRADE A BAND		
		,C1-0AM	SYS/WALL - STRIAE, GRADE A BAND		
		,TR-00E	SURFACE 3 SMOKE		
		,TR-00E	SURFACE 4 SMOKE		
			Tag(s): 1ST FL		
20	1	E2MP-438-B	MONO PANEL,SQ TOP CAP,W/POWER,48"W X 40"H	152.49	152.49
		(B)	POWER BASE		
		,C1-0AM	SYS/WALL - STRIAE, GRADE A BAND		
		,C1-	SYS/WALL - STRIAE, GRADE A		
			CONTINUED...		



PROPOSAL
PROPOSAL: 93938

DATE: 04/14/14
PROJECT #: 20-395

PROPOSAL FOR: CITY OF NOVI 45175 W. 10 MILE RD. NOVI, MI 48375	INSTALL AT: CITY OF NOVI 45175 W. 10 MILE RD. NOVI, MI 48375
---	---

COST CENTER:

SALESPERSON: JOEL MILLER	CLIENT: 010030	YOUR P/O:	QUOTE VALID
-----------------------------	-------------------	-----------	-------------

#	QTY	PRODUCT	DESCRIPTION	SELL	EXTENDED
		0AM ,TR- 00E ,TR- 00E	BAND SURFACE 3 SMOKE SURFACE 4 SMOKE Tag(s): 1ST FL		
21	3	E2MP-462-B	MONO PANEL, SQ TOP CAP, W/POWER, 48"W X 64"H (B) POWER BASE ,C1- SYS/WALL - STRIAE, GRADE A 0AM BAND ,C1- SYS/WALL - STRIAE, GRADE A 0AM BAND ,TR- SURFACE 3 00E SMOKE ,TR- SURFACE 4 00E SMOKE Tag(s): 1ST FL	167.31	501.93
22	3	E2PC-62 () ,TR- 00E	90DEG FINISH POST, PAINTED, 64"H STANDARD VERSION SURFACE 1 SMOKE CONTINUED...	16.38	49.14



PROPOSAL

PROPOSAL: 93938

DATE: 04/14/14
PROJECT #: 20-395

PROPOSAL FOR:
CITY OF NOVI
45175 W. 10 MILE RD.
NOVI, MI 48375

INSTALL AT:
CITY OF NOVI
45175 W. 10 MILE RD.
NOVI, MI 48375

COST CENTER:

SALESPERSON: JOEL MILLER CLIENT: 010030 YOUR P/O: QUOTE VALID

#	QTY	PRODUCT	DESCRIPTION	SELL	EXTENDED
		,TR-00E	SURFACE 2 SMOKE		
		,TR-00E	SURFACE 3 SMOKE		
23	1	E2PS-38	180DEG FINISH POST, PAINTED, 40"H	12.48	12.48
		()	FULL-HEIGHT		
		,TR-00E	SURFACE 1 SMOKE		
		,TR-00E	SURFACE 2 SMOKE		
		,TR-00E	SURFACE 3 SMOKE		
24	4	E2TF-308	SINGLE UPPER INSERT-FOR MONO PANEL CORE, FABRIC, 36"W X 8"H	13.07	52.28
		,TK-0AR	TUSCAN, GRADE A ARNO		
		,TR-00E	SURFACE 2 SMOKE		



PROPOSAL
PROPOSAL: 93938

DATE: 04/14/14 PROJECT #: 20-395	
PROPOSAL FOR: CITY OF NOVI 45175 W. 10 MILE RD. NOVI, MI 48375	INSTALL AT: CITY OF NOVI 45175 W. 10 MILE RD. NOVI, MI 48375

COST CENTER:							
SALESPERSON:		CLIENT:		YOUR P/O:		QUOTE VALID	
JOEL MILLER		010030					
#	QTY	PRODUCT	DESCRIPTION	SELL	EXTENDED		
25	2	HTB-3016 () ,C1- 0AM	TACKBOARD 30" X 16" FOR ACOUSTICAL PANEL SYS/WALL - STRIAE, GRADE A BAND	32.37	64.74		
26	4	SPLA-8596 () ,TK- 0AR	TACKBOARD 36" X 08" FOR ACOUSTICAL PANEL TUSCAN, GRADE A ARNO	34.13	136.52		
27	12	HTB-3616 () ,TK- 0AR	TACKBOARD 36" X 16" FOR ACOUSTICAL PANEL TUSCAN, GRADE A ARNO Tag(s): 1ST FL	33.54	402.48		
28	7	LUTS-0054-1 6UEP (16UEP)	TASK LIGHT, ADAPTABLE 54" WIDE 6FT CORD, UNDR CAB, PRSMTIC LENS Tag(s): 1ST FL	38.61	270.27		
29	4	PRD-3-B (B) ,TR- 00E	DUPLEX RECEPTACLES (BOX OF 6) POWER BASE SURFACE 1 SMOKE Tag(s): 1ST FL	24.38	97.52		



PROPOSAL

PROPOSAL: 93938

DATE: 04/14/14
PROJECT #: 20-395

PROPOSAL FOR:
CITY OF NOVI
45175 W. 10 MILE RD.
NOVI, MI 48375

INSTALL AT:
CITY OF NOVI
45175 W. 10 MILE RD.
NOVI, MI 48375

COST CENTER:

SALESPERSON: JOEL MILLER CLIENT: 010030 YOUR P/O: QUOTE VALID

#	QTY	PRODUCT	DESCRIPTION	SELL	EXTENDED
30	2	UEFF-1672-Q ML (QML) ,TR- 00E ,P8- 0AW ,LR- 0BP	UPPER STORAGE,UNIGROUP,FD STD MT,FRAMED DOOR 72" TRANSLUCENT DOOR,ON-MODULAR,LOCK SURFACE 1 SMOKE ACRYLIC/PATTERNED (MOXIE) ACRYLIC WHITE LOCK PLUG/RING/GROMMET COLORS CHROME (BRIGHT NICKEL PLATE)	252.53	505.06
31	2	UEFS-1666-P ML (PML) ,TR- 00E ,TR- 00E ,LR- 0BP	UPPER STORAGE,UNIGROUP TOO,FLIPPER DOOR,SQUARE,STD MT 66" PAINTED DOOR,STD MOUNT,ON-MOD,LOCKING SURFACE 1 SMOKE SURFACE 2 SMOKE LOCK PLUG/RING/GROMMET COLORS CHROME (BRIGHT NICKEL PLATE)	159.51	319.02
32	3	UEFS-1672-P ML (PML)	UPPER STORAGE,UNIGROUP TOO,FLIPPER DOOR,SQUARE,STD MT 72" PAINTED DOOR,STD MOUNT,ON-MOD,LOCKING CONTINUED...	188.18	564.54



PROPOSAL
PROPOSAL: 93938

DATE: 04/14/14
PROJECT #: 20-395

PROPOSAL FOR: CITY OF NOVI
45175 W. 10 MILE RD.
NOVI, MI 48375

INSTALL AT: CITY OF NOVI
45175 W. 10 MILE RD.
NOVI, MI 48375

COST CENTER:

SALESPERSON: JOEL MILLER CLIENT: 010030 YOUR P/O: QUOTE VALID

#	QTY	PRODUCT	DESCRIPTION	SELL	EXTENDED
		, TR- 00E	SURFACE 1 SMOKE		
		, TR- 00E	SURFACE 2 SMOKE		
		, LR- 0BP	LOCK PLUG/RING/GROMMET COLORS CHROME (BRIGHT NICKEL PLATE)		
33	3	VLRD-0230-L A	V SERIES, LATERAL FILE, TWO-HIGH 30W, 1 LOCK	206.38	619.14
		(LA)	FULL STEEL PULL, ATTACHED		
		, TR- 00E	SURFACE 1 SMOKE		
		, LR- 0BP	LOCK PLUG/RING/GROMMET COLORS CHROME (BRIGHT NICKEL PLATE)		
			Tag(s): 1ST FL		
34	7	VPAH-24-L	V SERIES, PEDESTAL, B/B/F, ATTACHED	137.02	959.14
		(L)	, PTD FRT 24D, 1 LOCK		
		, TR- 00E	FULL STEEL PULL SURFACE 1 SMOKE		
		, LR- 0BP	LOCK PLUG/RING/GROMMET COLORS CHROME (BRIGHT NICKEL PLATE)		
			CONTINUED...		



PROPOSAL
PROPOSAL: 93938

DATE: 04/14/14
PROJECT #: 20-395

PROPOSAL FOR:	INSTALL AT:
CITY OF NOVI	CITY OF NOVI
45175 W. 10 MILE RD.	45175 W. 10 MILE RD.
NOVI, MI 48375	NOVI, MI 48375

COST CENTER:

SALESPERSON:	CLIENT:	YOUR P/O:	QUOTE VALID
JOEL MILLER	010030		

#	QTY	PRODUCT	DESCRIPTION	SELL	EXTENDED
			Tag(s): 1ST FL		
35	2	VPAJ-24-L	V SERIES, PEDESTAL, F/F, ATTACHED, P TD FRT 24D, 1 LOCK (L) FULL STEEL PULL , TR- SURFACE 1 00E SMOKE , LR- LOCK PLUG/RING/GROMMET COLORS 0BP CHROME (BRIGHT NICKEL PLATE) Tag(s): 1ST FL	128.18	256.36
36	2	VPAJ-30-L	V SERIES, PEDESTAL, F/F, ATTACHED, P TD FRT 30D, 1 LOCK (L) FULL STEEL PULL , TR- SURFACE 1 00E SMOKE , LR- LOCK PLUG/RING/GROMMET COLORS 0BP CHROME (BRIGHT NICKEL PLATE)	141.10	282.20



PROPOSAL
PROPOSAL: 93938

DATE: 04/14/14
PROJECT #: 20-395

PROPOSAL FOR: CITY OF NOVI 45175 W. 10 MILE RD. NOVI, MI 48375	INSTALL AT: CITY OF NOVI 45175 W. 10 MILE RD. NOVI, MI 48375
---	---

COST CENTER:

SALESPERSON: JOEL MILLER	CLIENT: 010030	YOUR P/O:	QUOTE VALID
-----------------------------	-------------------	-----------	-------------

#	QTY	PRODUCT	DESCRIPTION	SELL	EXTENDED
37	1	WUCE-3672-L JSAL44 (LJSAL44) , OH- OAE , HP- OAE	CORNER, 90DEG WRAP-AROUND EXTENDED WORKSURFACE 36 X 72 LAM, EDGBND, STD, WRWAY, LH, 24, 24 LAMINATE MAPLE LAMINATE/T-MOLD/EDGE BAND MAPLE	165.36	165.36
38	1	WUCE-3674-L JSAR44 (LJSAR44) , OH- OAE , HP- OAE	CORNER, 90DEG WRAP-AROUND EXTENDED WORKSURFACE 36 X 74 LAM, EDGBND, STD, WRWAY, RH, 24, 24 LAMINATE MAPLE LAMINATE/T-MOLD/EDGE BAND MAPLE	228.74	228.74
39	1	WUCE-4872-L JSAL44 (LJSAL44) , OH- OAE , HP- OAE	CORNER, 90DEG WRAP-AROUND EXTENDED WORKSURFACE 48 X 72 LAM, EDGBND, STD, WRWAY, LH, 24, 24 LAMINATE MAPLE LAMINATE/T-MOLD/EDGE BAND MAPLE	171.21	171.21



PROPOSAL
 PROPOSAL: 93938

DATE: 04/14/14
 PROJECT #: 20-395

PROPOSAL FOR: CITY OF NOVI
 45175 W. 10 MILE RD.
 NOVI, MI 48375

INSTALL AT: CITY OF NOVI
 45175 W. 10 MILE RD.
 NOVI, MI 48375

COST CENTER:

SALESPERSON: JOEL MILLER CLIENT: 010030 YOUR P/O: QUOTE VALID

#	QTY	PRODUCT	DESCRIPTION	SELL	EXTENDED
40	2	WUCE-4872-L JSAR44 (LJSAR44) , OH- OAE , HP- OAE	CORNER, 90DEG WRAP-AROUND EXTENDED WORKSURFACE 48 X 72 LAM, EDGBND, STD, WRWAY, RH, 24, 24 LAMINATE MAPLE LAMINATE/T-MOLD/EDGE BAND MAPLE	171.21	342.42
41	2	SPLH-6375 (LJSAL34) , OH- OAE , HP- OAE	CORNER, 90DEG WRAP-AROUND TRANS EXTENDED WORKSURFACE 42 X 72 LAM, EDGBND, STD, WRWAY, LH, 19 EXACT, 24 LAMINATE MAPLE LAMINATE/T-MOLD/EDGE BAND MAPLE	198.71	397.42
42	1	SPLH-6374 (LJSAR43) , OH- OAE , HP- OAE	CORNER, 90DEG WRAP-AROUND TRANS EXTENDED WORKSURFACE 42 X 72 LAM, EDGBND, STD, WRWAY, RH, 24, 19 EXACT LAMINATE MAPLE LAMINATE/T-MOLD/EDGE BAND MAPLE	198.71	198.71



PROPOSAL

PROPOSAL: 93938

DATE: 04/14/14
PROJECT #: 20-395

PROPOSAL FOR:
CITY OF NOVI
45175 W. 10 MILE RD.
NOVI, MI 48375

INSTALL AT:
CITY OF NOVI
45175 W. 10 MILE RD.
NOVI, MI 48375

COST CENTER:

SALESPERSON: JOEL MILLER CLIENT: 010030 YOUR P/O: QUOTE VALID

#	QTY	PRODUCT	DESCRIPTION	SELL	EXTENDED
43	1	WUCX-4872-L JSAL45 (LJSAL45) , OH- 0AE , HP- 0AE	CORNER, 90DEG WRAP-AROUND TRANS EXTENDED WORKSURFACE 48 X 72 LAM, EDGBND, STD, WRWAY, LH, 24, 30 LAMINATE MAPLE LAMINATE/T-MOLD/EDGEBAND MAPLE	191.30	191.30
44	1	WUCX-6072-L JSAR54 (LJSAR54) , OH- 0AE , HP- 0AE	CORNER, 90DEG WRAP-AROUND TRANS EXTENDED WORKSURFACE 60 X 72 LAM, EDGBND, STD, WRWAY, RH, 30, 24 LAMINATE MAPLE LAMINATE/T-MOLD/EDGEBAND MAPLE	201.83	201.83
45	2	WURA-2430-L JSA (LJSA) , OH- 0AE , HP- 0AE	RECT WORKSURFACE 24D X 30W LAM, EDGBND, STD CORE, W/WIREWAY LAMINATE MAPLE LAMINATE/T-MOLD/EDGEBAND MAPLE	41.34	82.68



PROPOSAL

PROPOSAL: 93938

DATE: 04/14/14
PROJECT #: 20-395

PROPOSAL FOR:
CITY OF NOVI
45175 W. 10 MILE RD.
NOVI, MI 48375

INSTALL AT:
CITY OF NOVI
45175 W. 10 MILE RD.
NOVI, MI 48375

COST CENTER:

SALESPERSON: JOEL MILLER CLIENT: 010030 YOUR P/O: QUOTE VALID

#	QTY	PRODUCT	DESCRIPTION	SELL	EXTENDED
46	1	WURA-3036-L JSA (LJSA) , OH- OAE , HP- OAE	RECT WORKSURFACE 30D X 36W LAM, EDGBND, STD CORE, W/WIREWAY LAMINATE MAPLE LAMINATE/T-MOLD/EDGE BAND MAPLE	62.60	62.60
47	1	WURA-3048-L JSA (LJSA) , OH- OAE , HP- OAE	RECT WORKSURFACE 30D X 48W LAM, EDGBND, STD CORE, W/WIREWAY LAMINATE MAPLE LAMINATE/T-MOLD/EDGE BAND MAPLE	71.76	71.76
48	7	ZEBA-0000-P L (PL)	BRACKET, SIDE, FOR UNIGROUP/TOO/PLACES PAINTED, LEFT HAND	2.73	19.11
49	7	ZEBA-0000-P R (PR)	BRACKET, SIDE, FOR UNIGROUP/TOO/PLACES PAINTED, RIGHT HAND	2.73	19.11
50	7	ZEBD-1600-P P	CNTLVR BRKT, UNIGROUP/TOO/PLACES, STAND ARD, 16.5"D CONTINUED...	15.02	105.14



PROPOSAL
PROPOSAL: 93938

DATE: 04/14/14
PROJECT #: 20-395

PROPOSAL FOR: CITY OF NOVI 45175 W. 10 MILE RD. NOVI, MI 48375	INSTALL AT: CITY OF NOVI 45175 W. 10 MILE RD. NOVI, MI 48375
---	---

COST CENTER:

SALESPERSON: JOEL MILLER	CLIENT: 010030	YOUR P/O:	QUOTE VALID
-----------------------------	-------------------	-----------	-------------

#	QTY	PRODUCT	DESCRIPTION	SELL	EXTENDED
		(PP)	PAINTED (BLACK), PAIR		
51	5	ZEBD-1600-P L	CNTLVR BRKT, UNIGROUP/TOO/PLACES, STAND ARD, 16.5"D	8.00	40.00
		(PL)	PAINTED (BLACK), LEFT HAND		
52	4	ZEBD-1600-P R	CNTLVR BRKT, UNIGROUP/TOO/PLACES, STAND ARD, 16.5"D	8.00	32.00
		(PR)	PAINTED (BLACK), RIGHT HAND		
53	7	ZUBF-0000-P N (PN)	Flush Mount Plate PAINTED, NON-HANDED	3.71	25.97
54	10	ZEBR-0000-P N (PN)	Rear-Corner Bracket PAINTED, NON-HANDED	2.73	27.30
55	7	LSET-4 , LX- OBP	HW, LOCK, PLUG AND KEY, SET-LSET4 LOCK COLOR CHROME	0.00	0.00



PROPOSAL
PROPOSAL: 93938

DATE: 04/14/14
PROJECT #: 20-395

PROPOSAL FOR: CITY OF NOVI 45175 W. 10 MILE RD. NOVI, MI 48375	INSTALL AT: CITY OF NOVI 45175 W. 10 MILE RD. NOVI, MI 48375
---	---

COST CENTER:

SALESPERSON: JOEL MILLER	CLIENT: 010030	YOUR P/O:	QUOTE VALID
-----------------------------	-------------------	-----------	-------------

#	QTY	PRODUCT	DESCRIPTION	SELL	EXTENDED
56	1	LABOR	DISASSEMBLE (7) EXISTING STATIONS AND DISPOSE OF STEELCASE 9000. OVERTIME.	3,350.00	3,350.00
		~	RECEIVE, DELIVER AND INSTALL (7) NEW UNIGROUP STATIONS PER DRAWING DATED 3/26/14. REGULAR TIME. NON-UNION.		
		~			
		~			

Thank you for the opportunity to quote on your requirements.

DEPOSIT REQUIRED	0.00	SUBTOTAL.....:	18,157.51
ACCEPTED BY _____			
DATE ACCEPTED _____			
		TOTAL.....:	=====
			18,157.51

TERMS AND CONDITIONS

1. This Proposal is not binding unless signed, returned to, and accepted by, INTERIOR SYSTEMS CONTRACT GROUP INC. (DBA "iscg").
2. The Buyer agrees to provide credit information if requested by **iscg**. **iscg** reserves the right to modify the terms of this Proposal, including deposit requirements, based on the financial information obtained.
3. The Buyer warrants that the credit application and other financial statements submitted to **iscg** are true and correct.
4. This order may not be changed or canceled unless agreed to by the Buyer and the CEO or President, of **iscg**, in writing. If canceled, the Buyer remains responsible for all costs incurred for design, re-stocking and other order specific charges.
5. All applicable taxes will be added at invoicing, unless included in the Proposal, and are the responsibility of the Buyer.
6. The Buyer agrees to pay **iscg** within 30 days of invoice date. Should Buyer be unable to accept delivery when **iscg** receives product, Buyer agrees to be invoiced for the total, with 90% of that total to be paid in 30 days. The balance will be paid 10 days after delivery. Payment in full is required on all delivered product; payment for missing or damaged product only may be withheld until problem is resolved or product replacement is delivered. **iscg** will warehouse for 30 days at no charge, thereafter a monthly charge will be incurred, based upon square footage used.
7. In the event construction delays or other causes not within **iscg's** control force postponement of the delivery and/or installation, the merchandise can be stored until installation can take place and will be considered accepted by the Buyer for purposes of payment. The Buyer agrees to pay any storage charges incurred.
8. When partial deliveries are made, the Buyer will be invoiced for merchandise delivered. No payment shall be withheld by Buyer because of partial delivery on the entire order.
9. Delivery and installation will be made during normal business hours utilizing non-union labor. Buyer agrees to pay any additional charges for labor costs resulting from overtime work, and/or union labor, performed at the Buyer's request.
10. **iscg** will charge interest at the rate of 18% per annum (or the maximum rate permitted by law) on all past due accounts.
11. Buyer grants a security interest in the merchandise described in this Proposal until payment has been received in full. Buyer agrees to protect **iscg's** title and to keep merchandise free and clear of all claims and liens until **iscg** has been paid in full.
12. **iscg** is authorized to file a UCC-1 to further protect its security interest in any unpaid merchandise.
13. **iscg** will use its best effort to obtain all products within the manufacturer's posted lead time. Buyer understands and agrees that **iscg** is not responsible for a manufacturer's inability to meet their estimated or expected ship dates. There is no offset, or other price reduction, due to a manufacturer delay.
14. Buyer must keep the job site free and clear of debris before and during the installation. Hoisting or elevator service and adequate facilities for offloading, staging, moving, and handling of merchandise must be provided by the Buyer and without charge to **iscg**. The Buyer is also responsible for securing all necessary building permits and licenses.
15. Buyer shall be solely responsible for any damage to or loss of merchandise after delivery. Until all amounts due to **iscg** have been paid in full, Buyer shall maintain in force a policy of fire and extended coverage insurance on all merchandise for its full value and with loss payable to **iscg**. Upon request, Buyer shall furnish **iscg** with Certificate of Insurance.
16. **iscg** assigns all rights derived from the manufacturer's warranties to Buyer to the extent such rights are assignable.
17. Any controversy or claim arising out of or relating to this Agreement or any breach thereof, shall be settled in accordance with the Rules of the American Arbitration Association and judgment upon the award may be entered in any court having unpaid merchandise.
18. Buyer agrees to pay attorney's fee and costs incurred by **iscg** in the enforcement of these Terms and Conditions, including but not limited to payment and realization on the security interest granted herein.
19. The actual Proposal and these Terms and Conditions represent the entire Agreement between Buyer and **iscg** which may not be changed without mutual written authorization.

10/31/08

UniGroup[®] Too

HAWORTH[®]



What can you do with UniGroup Too?

Sure, underneath is one of the industry's most widely installed furniture systems, renowned for its durability and simplicity. But with squared top trim and tight tolerances, it's sleek and rectilinear, sophisticated and classic. Scalable panel and component options can meet your interior needs with ease.

UniGroup Too—a fresh look for the essential office.

Panel: K36, J16 and Maharam Sharkskin Promise
Trim: Chalk, Worksurfaces Espresso Walnut, Edge Band
Storage X Series® in Espresso Walnut and
21 arm Champagne Translucent with Taper Pulls
Task Seating X99™ in Brisa French Vanilla, Metallic Silver Trim
Lounge Seating Hello™ in Maharam Repeat Classic Stripe Inca
and Maharam Strut Lemongrass

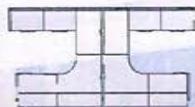



Panel: Shimmy, Wx, Guest, Landscape, Full-Move
Trim: Chair Worksurfaces, Fabric, Cabinet, 24" x 36"
Overhead Storage: Chair
Storage: X-Series, 41" High
Seating: X-Series, 18" x 24" x 24", 18" x 24" x 24"
Guest Seating: LOOT, 18" x 24" x 24", 18" x 24" x 24"

You can customize your space with monolithic or segmented panels. Select wood to contrast or complement the fabrics you choose.



Panels Maharam Gini Ice
Trim Metallic Silver Worksurface Chalk, Concrete
Storage X Series In Metallic Silver with Mesh Perforated Metal with Radius Pull
Slat Pad Metallic Silver with Jump™ Stuff Mini Shell In Chalk
Task Seating X19 In Knadat Pause 770, Metallic Silver Trim
Lounge Seating Hello In Maharam Align Spring and Knadat Pause 770

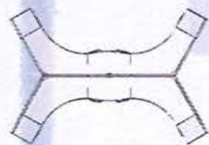

You can create task and open spaces with the same components. Pair shimmering fabrics with slat tiles and marvel at how rich and textured a panel can be. Slim, too, since rigid slat inserts create a flatter look. Segmented panels create an architectural look in a 120-degree layout. X Series® stationary and mobile storage help define workspace parameters and easily adapt to change.



Passerelle®
 Tilt Chair Work Surface, 1000 Series
 Overhead Storage Unit
 Storage X Series in Desk with Glass Top Panel
 Taskboard Multipoint Locking Panel
 Seating Pivotal Office Variety, Model 2000 Series



You can bring subtle sophistication to a basic application with work surfaces, file storage, and lightweight overhead storage units in built-in cubicles. And bring Power Base™, the industry's most intelligent power delivery system, plus unmatched data management that easily integrates tools and technology. A contrasting fabric on the taskboards adds interest to a shared workspace.

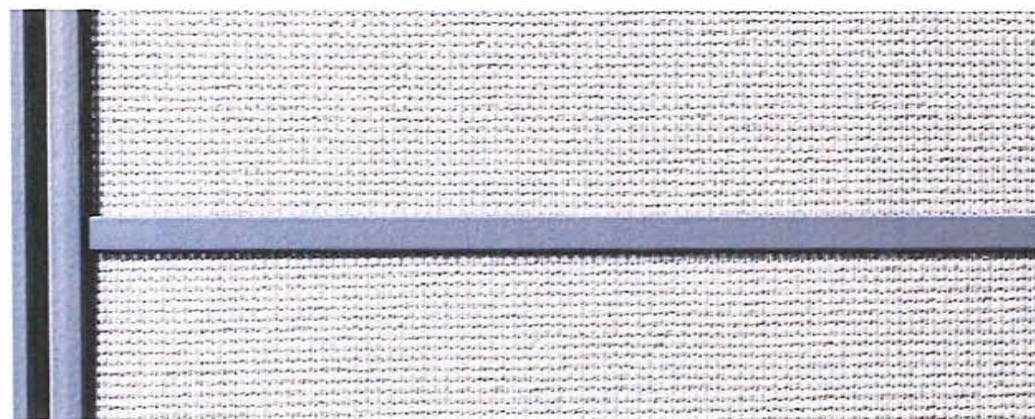

A fresh look for the essential office.

UniGroup Too brings a sleek look that's loaded with possibilities. There are segmented panels for an architectural look, up-mount storage units for landscaping, and slat pads or markerboards for personalization. Plus, UniGroup Too works brilliantly with Haworth seating and storage.

So, what else can you do with UniGroup Too?

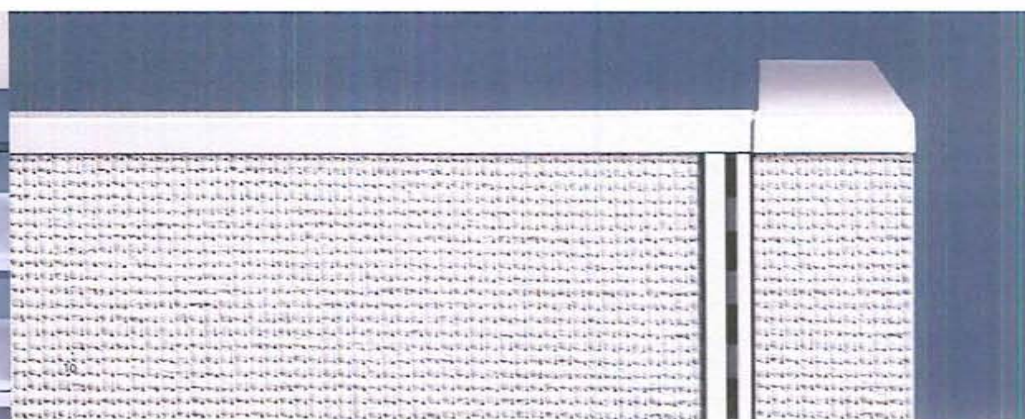
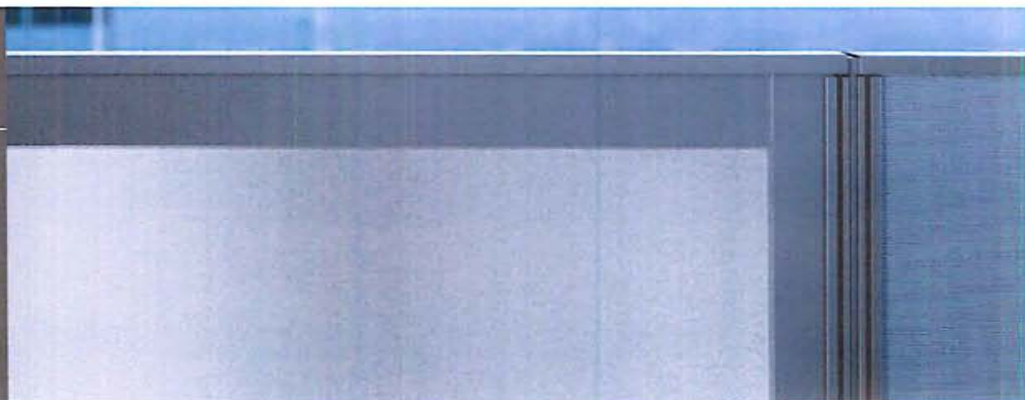



Panels Chalk, Laminate
Trim Metallic Silver **Worksurfaces** Chalk, Cascade
Tackboards Kvadrat Tundra 427
Storage X Series in Metallic Silver with Taper Pulls and Basic White Translucent
Seating LOOK in Kvadrat Tundra 427

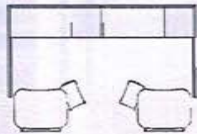

Add privacy with screens that attach directly to mobile tables and tie it all together for a clever impact with matching fabric on tackboards and mobile storage modules.



Panel Mirage Dream
Trim Platinum **Worksurfaces** Platinum, Edge Band
Tackboards Sio Smart
Overhead Storage Smoke and Basic White Translucent
Storage V Series* in Smoke, cushion in Mahatam Calyx Jungle
Seating LOOK in Brisa Cambridge Blue



You can add variety to the landscape with up-mount overhead storage units, achieving added height and privacy without added costs. In fact, you could design this entire workspace quickly and on a tight budget because all components, including the V Series* storage units, are readily available through Haworth's Start It Up Program.



Panel: Lino Dado, Circle
Trim: Metal, Gold
Worksurface: Espresso Walnut, Edge Band
Overhead Storage: Espresso Walnut
Storage: Espresso Espresso Walnut with Linear Finished Nickel Pulls
Seating: Hello, Lino with Spine Cherry Vanilla, Marble Silver from
Goert Seating with Espresso Walnut with Mahogany Wood at Candle

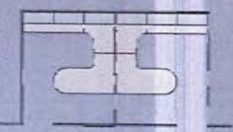

You can mix warm woods with cool metallic finishes to create private workspaces that welcome light through glass panels. Wood worksurfaces and overhead storage units complement X Series storage and Hello guest chairs.

You can do great things with a system this intuitive.

Durable

- UniGroup Too's monocoque construction integrates a rugged steel frame with a honeycomb core and a perforated steel skin. The unique universal hinge accommodates any panel angle and up to one million bends.

Simple

- Monolithic or segmented—you can mix and match and choose fabric, glass, or markerboard. Rigid panel inserts slide in and deliver a slimmer look than stretched fabric.
- Pre-finished trim rails eliminate the need for finish posts. Rails slide to offer easy access for panel removal—even at the center of a run.
- Power Base, the industry's most intelligent power delivery system, handles up to six circuits, 120 amps of power, and works with every building's wiring configuration.

- Built-in outlet covers slide to reveal powered panel outlets; they slide back if you need to configure for a non-powered panel.

Sustainable

UniGroup Too is GREENGUARD® certified.

UniGroup Too's standard panel has an average recycled content of 33% with 20% post-consumer content. Panels can be ordered with 100% recycled polyester fabrics.

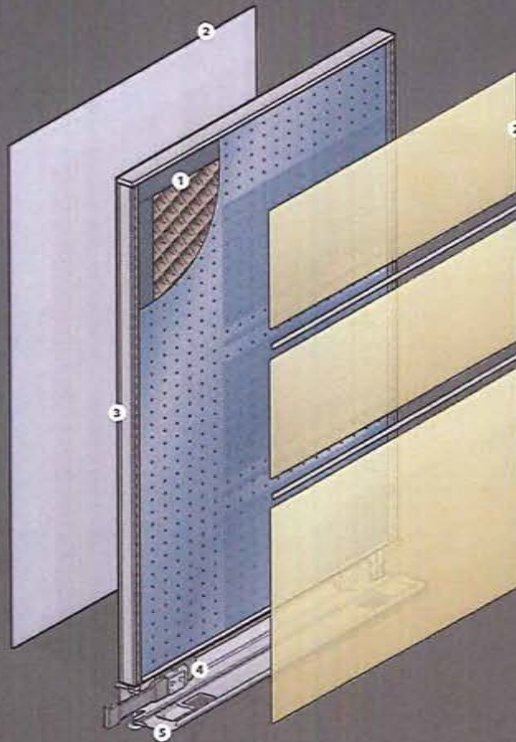

Worksurfaces

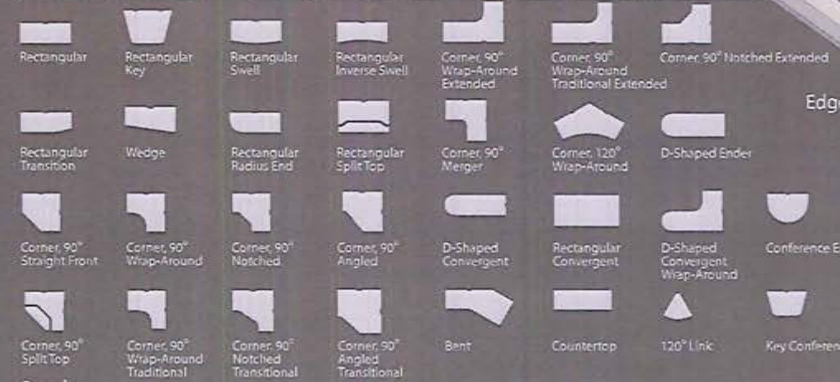

Edge Detail

T-mold
Edge Band
Cascade

Panels

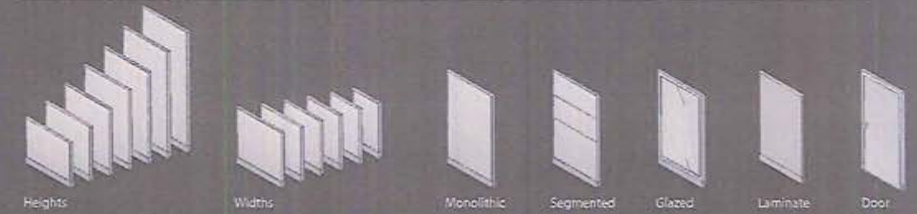

Inserts



Add-ons

Shelf

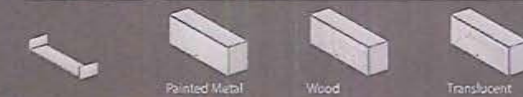

Overheads (Standard or Up-mount)

X Series Storage



V Series Storage

Jump Stuff Accessories

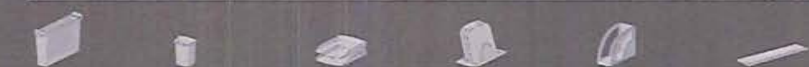

HAWORTH®

For more information call 800.344.2600 or 616.393.3000.
Download additional copies at haworth.com.

This brochure is printed on FSC certified U2®:XG™ paper, manufactured with electricity in the form of renewable energy (wind, hydro, biogas) and contains a minimum of 30% post-consumer recovered fiber. FSC is the global benchmark for responsible forest management.



Haworth is a registered trademark of Haworth, Inc.
Printed in USA ©Haworth, Inc. 2010 02.10 Item #1055

haworth.com | haworth-europe.com | haworth-asia.com



Project Name	DPS Front Office Cubical Replacement		DPS CIP#	DPS
Requesting Dept	Department of Public Services		Priority and Year	1 2014-15
Funding Sources	101-General		Useful Life (yrs)	15
Project Type	Replacement Project	Category	Buildings & Property	

Project/Item Description (Be specific, give bullet point details on replacement items (e.g., year, model, make, mileage, condition, vehicle number, how many miles of road, feet of sidewalks, etc.)	<p>This project would consist of the replacement of office cubicals for the main office area at the Department of Public Services Complex. The furniture proposed is manufactured by Haworth from their Unigroup Too line and pricing is based on the State of Michigan (MiDeal) cooperative purchasing contract.</p> <p>The budgeted amount includes removal of existing furniture, estimated electrical/data installation, new carpet installation, and the installation of new furniture.</p>
Alignment with City Goals (City Master Plans, Council goals, etc)	<p>Public Services</p> <p>City Councils long-term goal to fund capital improvements to Public Services facilities based on a long-term plan.</p>
Project Justification (Explain why it is needed or how it will change current services)	The Department of Public Services facility dates back to the 1980's and so does most of the office furniture. Many of the workstations are past the point of repair and are in need of replacement, not only due to safety concerns but also for cosmetics.
Operating Budget Impact (Will it generate revenue, or require additional staff or equipment?)	This project would require \$49,750 from the general fund.

Fiscal Summary:

Account Numbers	FY14-15	FY15-16	FY16-17	FY17-18	FY18-19	FY19-20
Capital						
Engineering Costs						
Other Costs (ROW)	101-442.00-934.000	\$49,750				
Construction Costs						
Total Project Costs:		\$49,750				
Operating						
Personal Services						
Supplies						
Other Svc/Charges						
Total Operating Costs:						
Total Outside Funding:	\$0.00	\$0.00	\$0.00	\$0.00	\$0.00	\$0.00

Preliminary Budget DPS

October 15 ,2013

<u>QTY:</u>	<u>Area:</u>	<u>Price:</u>	<u>Extended:</u>
3	"U" Shaped 8 x 8 Station	\$ 3,500.00	\$ 10,500.00
4	"L" Shaped 6 x 8 Station	\$ 3,000.00	\$ 12,000.00
5	File Cabinets	\$ 550.00	\$ 2,750.00

Sub Total: \$ 25,250.00

Overtime Labor: \$ 4,500.00

Disposal: \$ 1,500.00

Total: \$ 29,750.00

Construction Costs:

Carpet: \$14,000

Data/Electrical: \$6,000

Total Project Costs: \$49,750

I have reviewed and fully understand all of the design details, furniture systems components, filing/storage units, and seating shown on this plan. I approve and accept this drawing as the final design document. Any revisions made must be in writing and accepted by all below:

client: _____
date: _____
sales: _____
date: _____
designer: _____
date: _____

drawing title:
Proposed
Furniture
Layout -
OPTION G

project
number:
13131

sheet
number:
F - 1

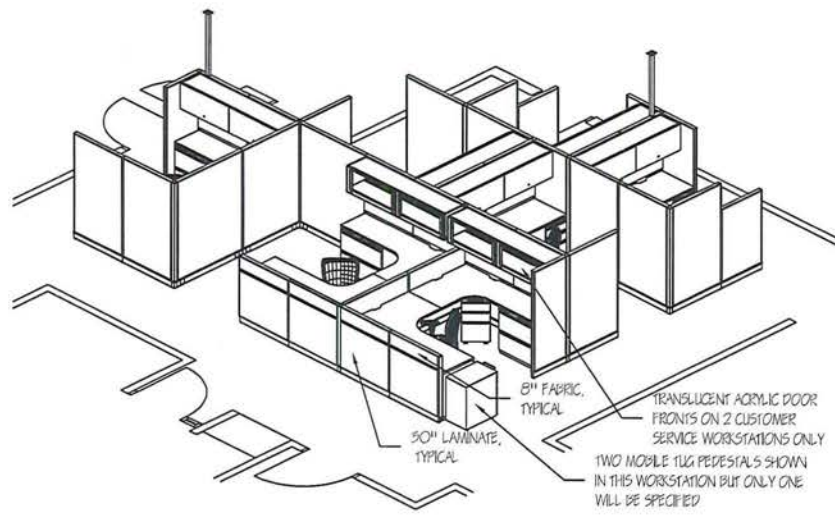

PERSPECTIVE VIEW A

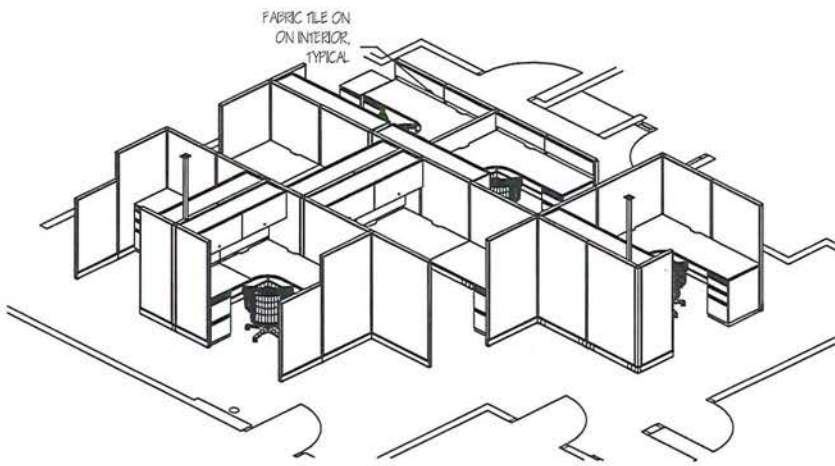

PERSPECTIVE VIEW B

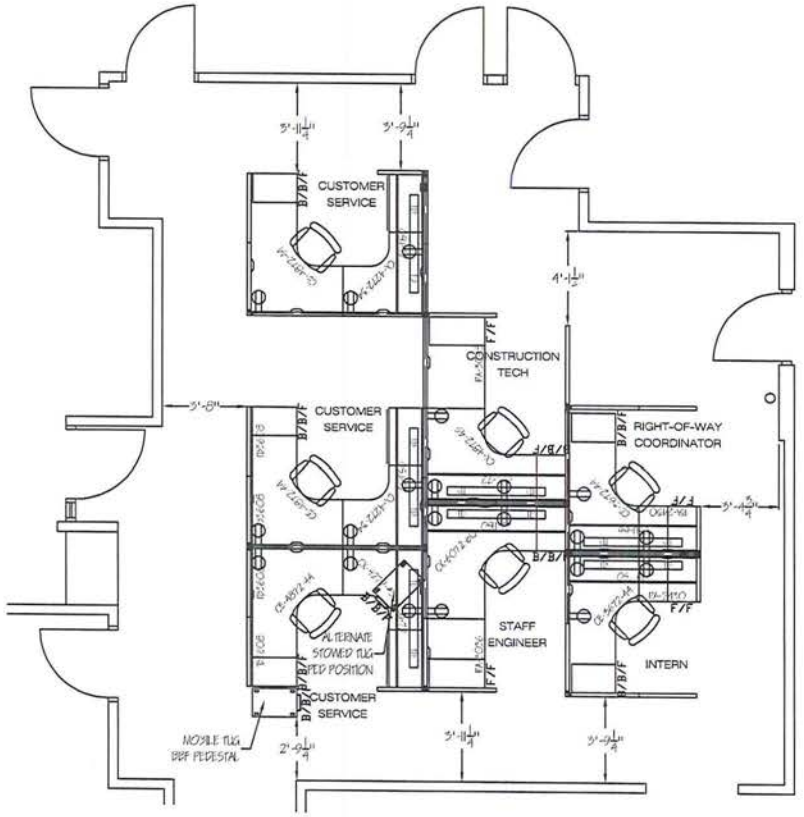

FLOOR PLAN