

Property Address

25795 Meadowbrook Rd.

Between Grand River & 11 Mile

Front View of Sign Face

Top View of Sign Faces

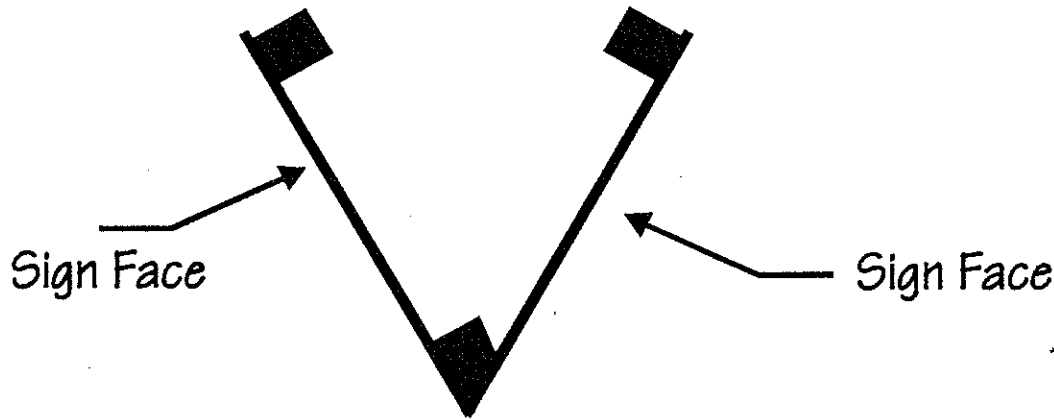

48"

 **CERTIFIED
MANAGEMENT
COMPANY**

FOR LEASE

248

476-6700

Bill McKeever
Brokers Protected
www.certifiedmanagement.net

72"

Notes: 4' x 6' x 1/2" MDO V-Shape Ground Sign - Single Faced - Height not to exceed
96" from ground - post holes dug 42" deep - 4" x 4" cedar post to support

MARQUE CORPORATE CENTERS NOVI TECHNICAL CENTER

MEADOWBROOK ROAD

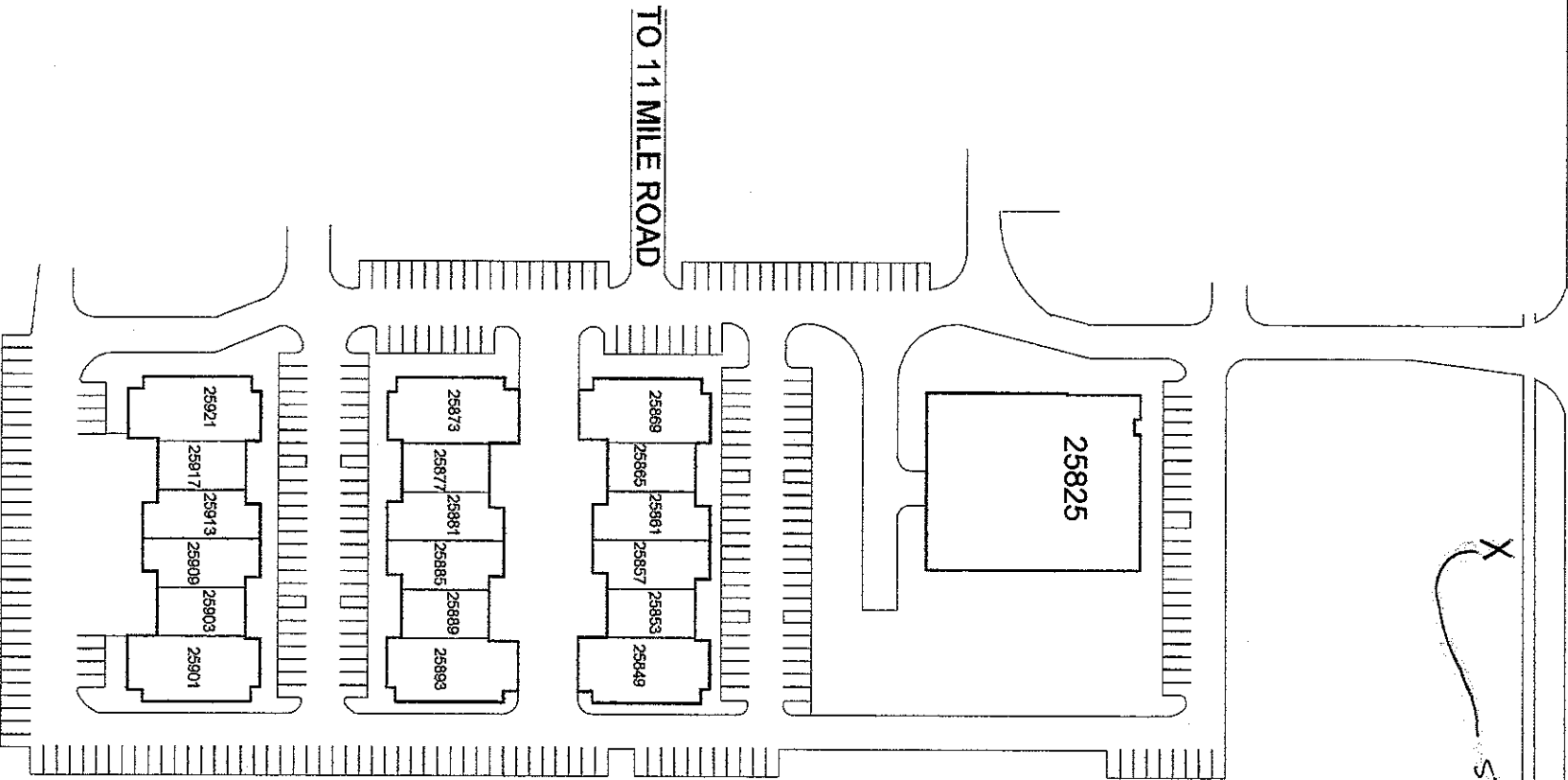

X
SIGN LOCATION
← N

